

# susdrain SuDS Champion Nomination Form 2021



## 1. Nomination details

Name of nominated person	Ryan Horngren	
Name of nominee's organisation or community	Civic Engineers	
Role of nominee in their organisation/community	Civil Design Engineer	
Role in championing SuDS	Design and implementation along with promoting the use of SuDS	
Experienced SuDS professional (worked with SuDS for more than 10 years) or 'rising star' (worked with SuDS for 10 years or fewer)	Established	Please indicate category No
	Rising star	Yes
Name and organisation of nominator	Phoebe Nickols - Citu	
Relationship of nominator to nominee	Client	

**2. Please give us some bullet points to explain how your nominee inspires, informs and influences SuDS, with examples of SuDS delivery.**

(Maximum 150 words total)

<p><b>Inspire</b> – how has your champion inspired others regarding SuDS?</p>	<ul style="list-style-type: none"> <li>• Whilst working together, Ryan compiled a comprehensive proposal for the maximisation of SuDS within the design. This inspired the design and our approach towards future developments.</li> <li>• Ryan developed a beautiful set of raingarden details (<b>presented below</b>) which inspired larger green infrastructure extents.</li> </ul>
<p><b>Inform</b> – how does your champion share good practice?</p>	<ul style="list-style-type: none"> <li>• To aid the SuDS selection process, Ryan conducted research into the options and listed advantages and disadvantages for each feature within its application.</li> <li>• Ryan explained the wider benefits of SuDS and the 4 pillars, along with financial benefits.</li> <li>• Internally, Ryan champions good practice by sharing guidance documents, developing and sharing typical details and organising CPD events.</li> </ul>
<p><b>Influence</b> – how has your champion dealt with challenges and shared their enthusiasm about SuDS?</p>	<ul style="list-style-type: none"> <li>• Ryan liaises continuously with LLFA's/LPA's/WaSC's to obtain early buy-in and drives a 'SuDS maximisation' approach.</li> <li>• To overcome the challenges that arise (typically due to adoption and maintenance), Ryan undertook research and produced a report which presented maintenance requirements and case studies. This report influenced the objecting authorities and secured project planning permission.</li> </ul>

Please submit this form to Louise Walker ([louise.walker@ciria.org](mailto:louise.walker@ciria.org))

**by 30<sup>th</sup> April 2021**

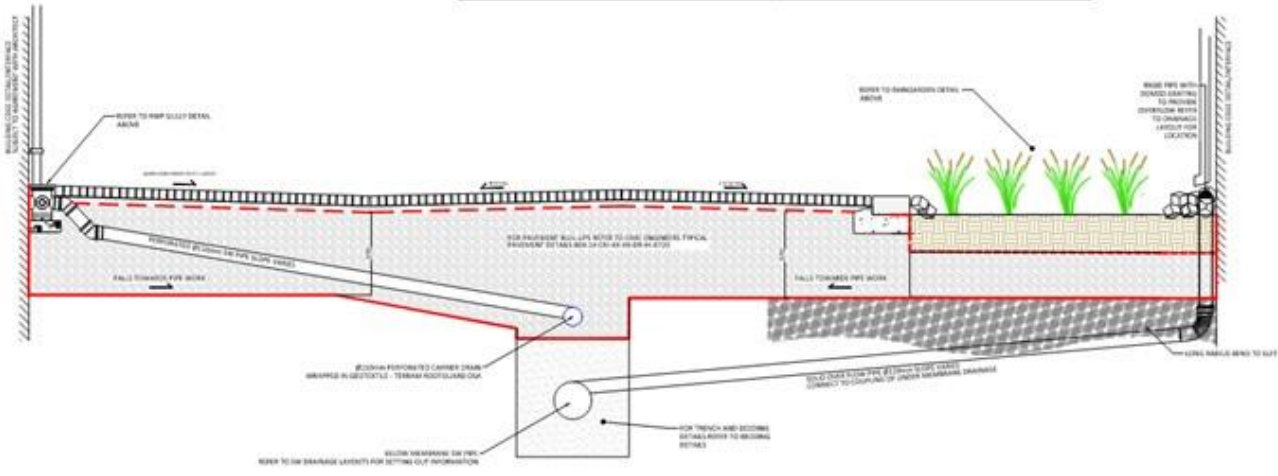

**TYPICAL SECTION THROUGH STREET**  
PLANTING AND GROWING MEDIUM TO LANDSCAPE ARCHITECTS SPECIFICATION  
SCALE: 1/5

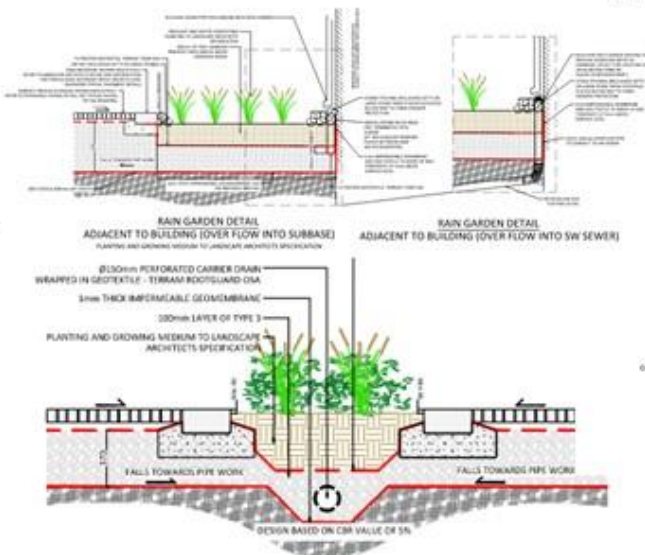

**TYPICAL RAIN GARDEN DETAIL WITHIN PAVING**  
PLANTING AND GROWING MEDIUM TO LANDSCAPE ARCHITECTS SPECIFICATION

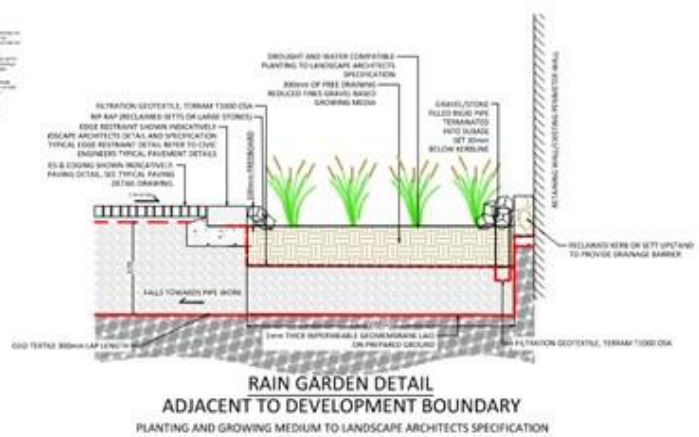

**RAIN GARDEN DETAIL ADJACENT TO DEVELOPMENT BOUNDARY**  
PLANTING AND GROWING MEDIUM TO LANDSCAPE ARCHITECTS SPECIFICATION

**CONCEALED DOWNPIPE DISCHARGE TO RAINGARDEN**

**DOWNPIPE DISCHARGE TO RAINGARDEN**

**RAINGARDEN WITHIN PAVING**

**RAINGARDEN WITHIN PAVING**

